

IZOTHERM

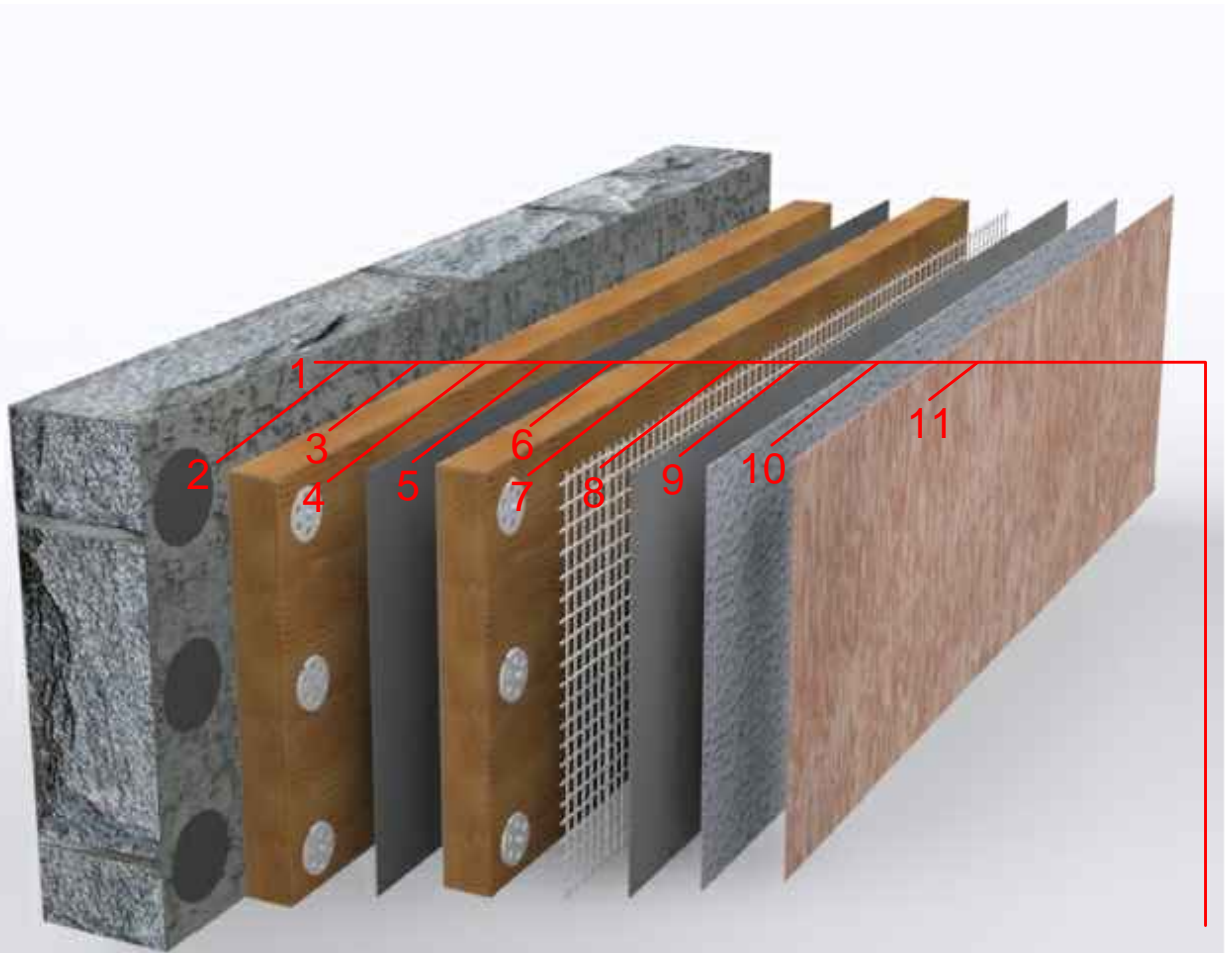

- 1 Wall
- 2 Plastofix adhesive
- 3 Mineralwool 50-175 kg/m3
- 4 Dowell 160mm Ø10
- 5 Plastoren plaster
- 6 Mineralwool 50-175 kg/m3
- 7 Dowell 160mm Ø10
- 8 Facade mesh 160 kg/m2
- 9 Plastoren plaster
- 10 Plastomin decorative top coat
- 11 Paint

инв.№подл.

подпись и дата

взам.инв.№

"IZOTHERM" LLP	
Project:	The component of the external insulation system
Customer:	
Completed:	

Multitherm® Insulation System

The component of the external insulation system

